

1

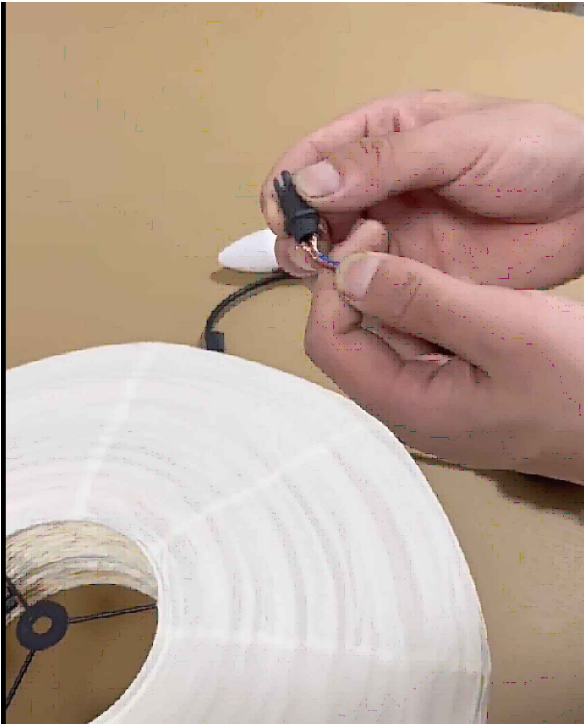

This end of the lock buckle thread is threaded into the wire first

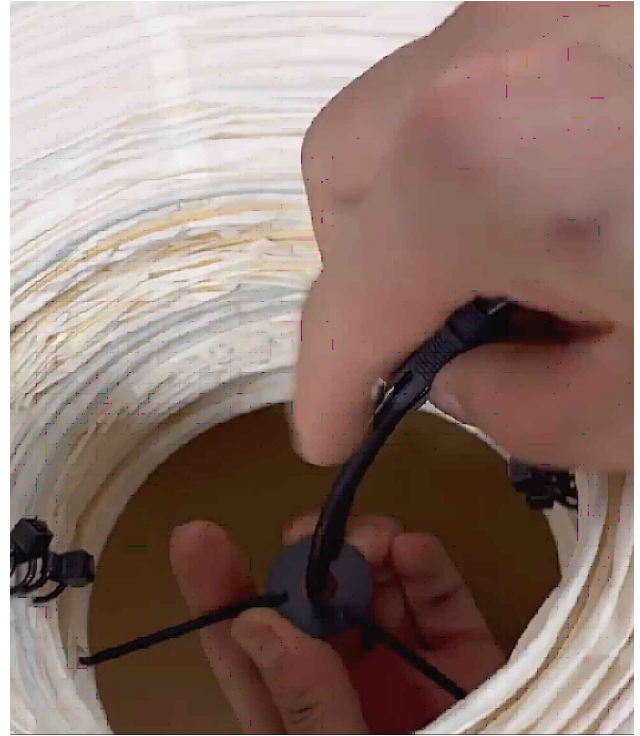

Then continue to thread the wire into the round hole at the top of the lampshade



Continue to thread the screw on the top of the lock wire buckle into the wire

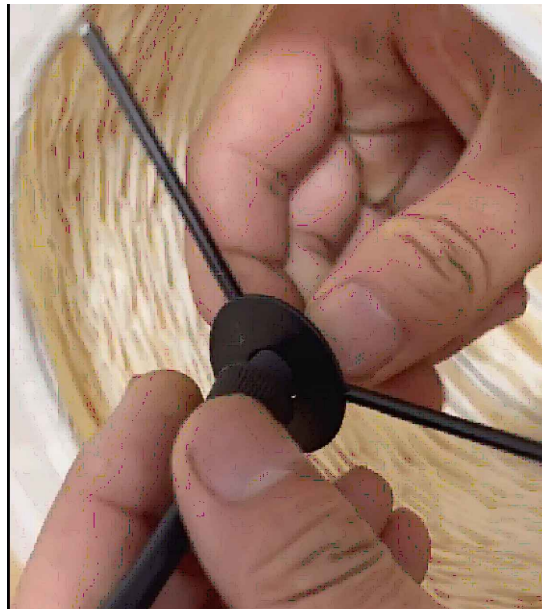

The wire can be pulled back and forth in the unscrewed state

The upper and lower parts of the lock cable buckle can be screwed (here you can adjust the position of the bulb in the lampshade)

2

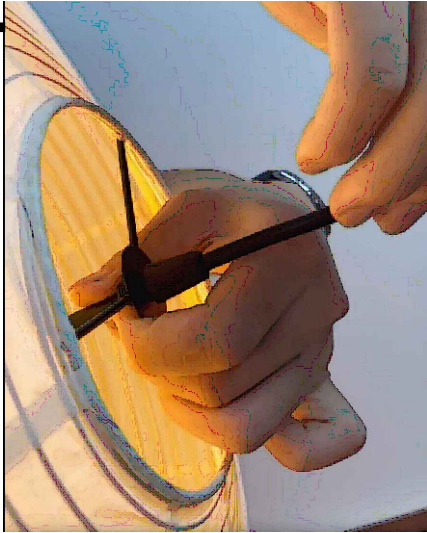

If the bulb is found to be in the wrong position after powering on, loosen the lock buckle and pull the wire to adjust the bulb position

Note: Be sure to adjust the position of the bulb before cutting the wire

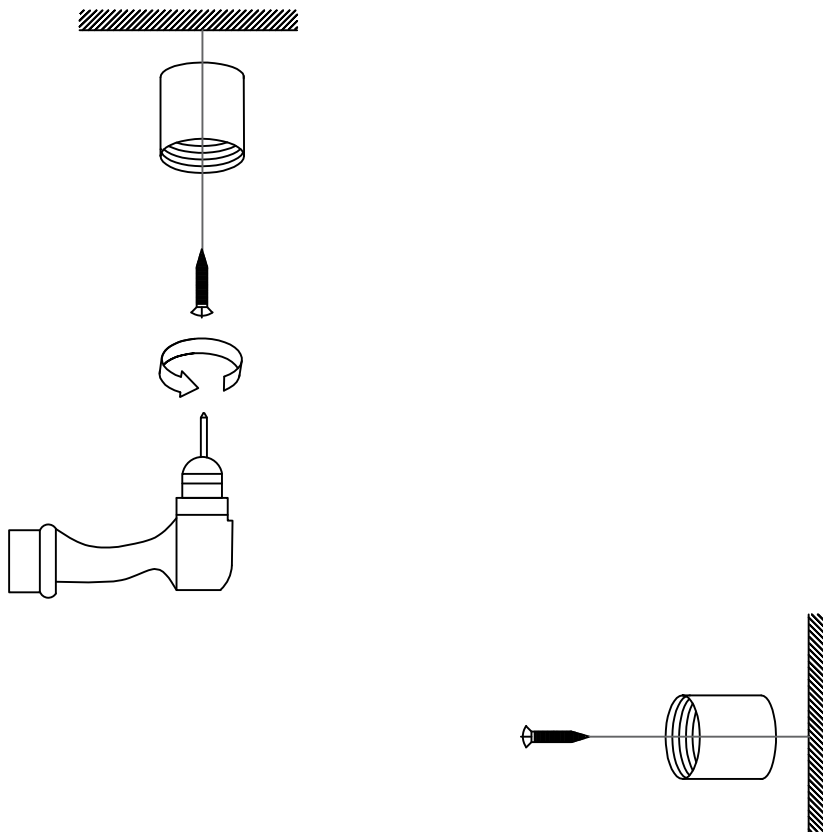

Use screws to fix the upper part of the small ceiling cover to the ceiling and wall

3

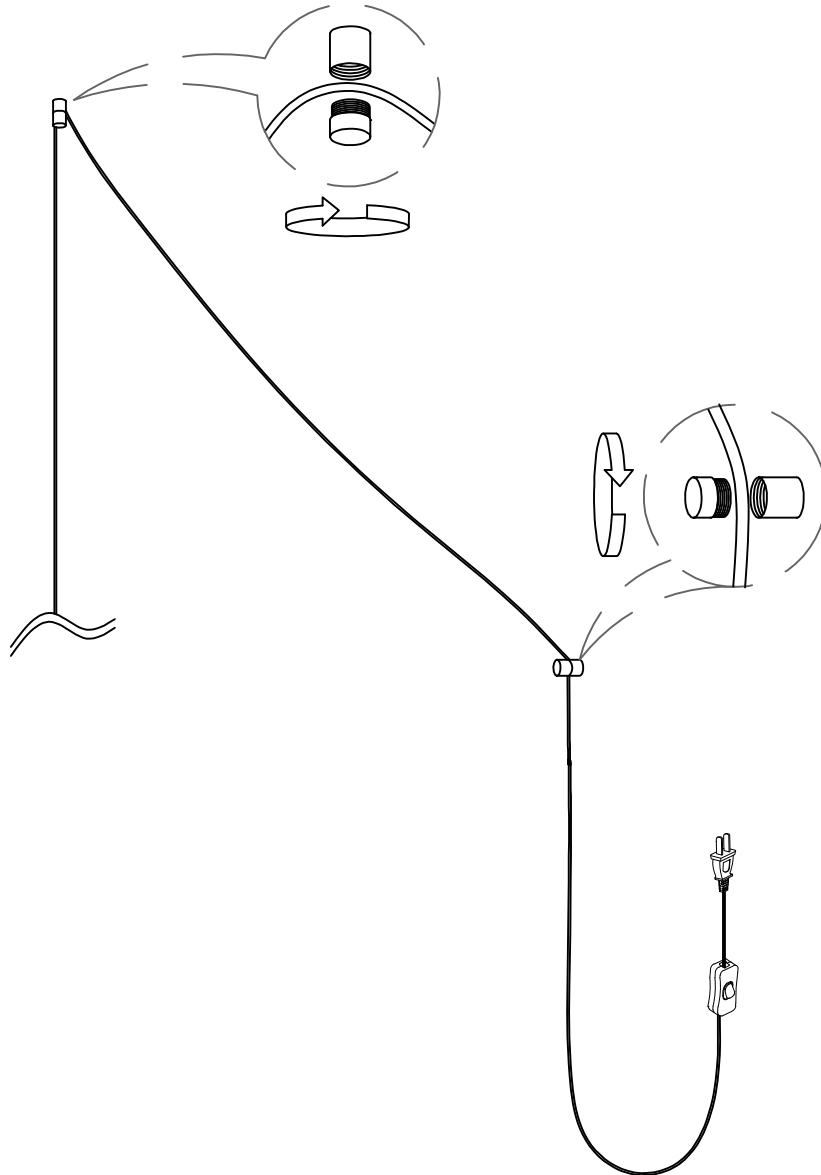

Insert the wire and twist it into the lower part of the small ceiling cover to fix it



Note: The lampshade can be replaced by yourself