

Drill holes in the ceiling and insert expansion screws

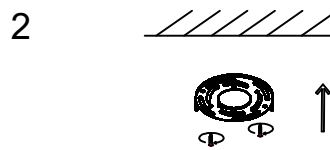

Install the hanging plate on the ceiling

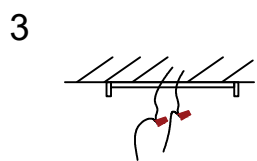

The electric wires in the home connect to the light fixtures

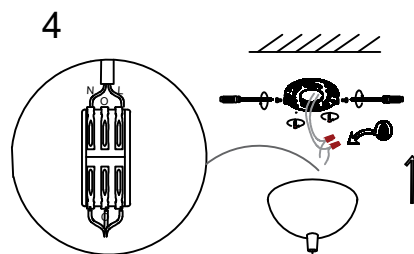

Install the lamp body on the hanging plate

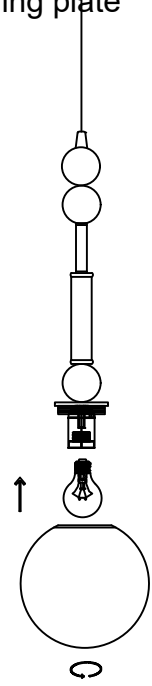

Install bulb and lampshade

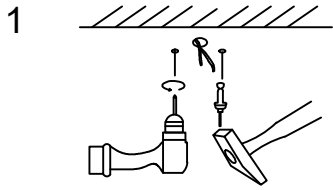

Drill holes in the ceiling and insert expansion screws

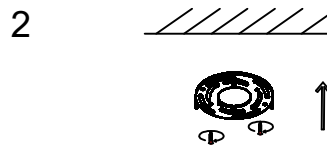

Install the hanging plate on the ceiling

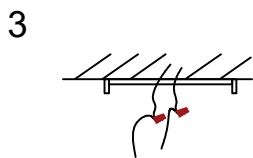

The electric wires in the home connect to the light fixtures

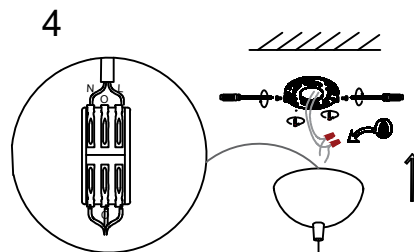

Install the lamp body on the hanging plate

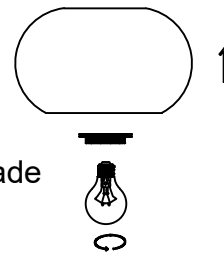

Install bulb and lampshade

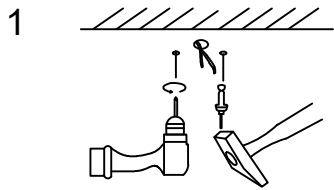

Drill holes in the ceiling and insert expansion screws

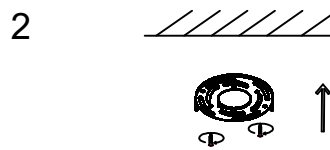

Install the hanging plate on the ceiling

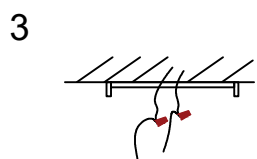

The electric wires in the home connect to the light fixtures

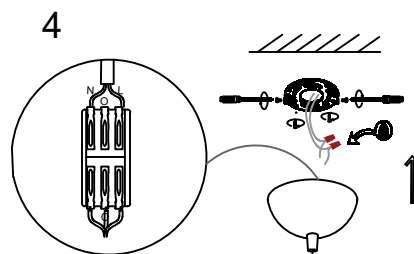

Install the lamp body on the hanging plate

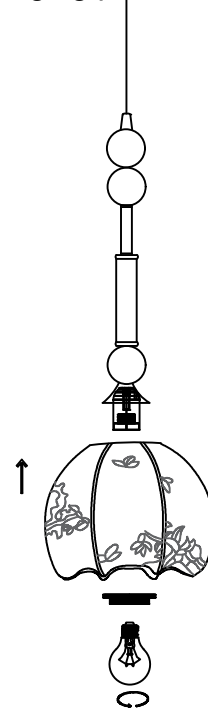

Install bulb and lampshade

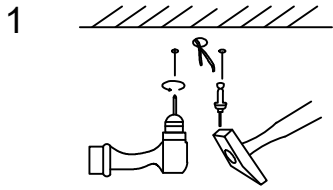

Drill holes in the ceiling and insert expansion screws

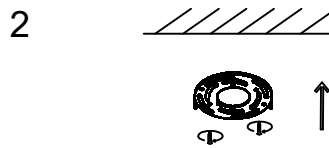

Install the hanging plate on the ceiling

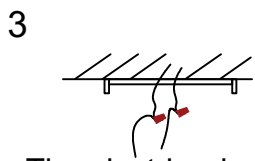

The electric wires in the home connect to the light fixtures

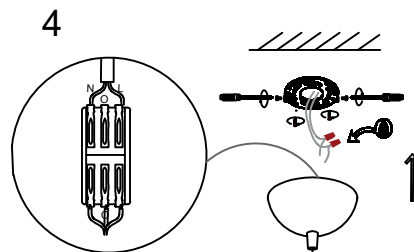

Install the lamp body on the hanging plate

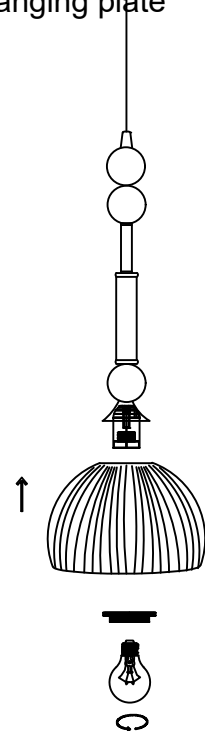

Install bulb and lampshade