

instruction manual

Assembling illustration

Model:

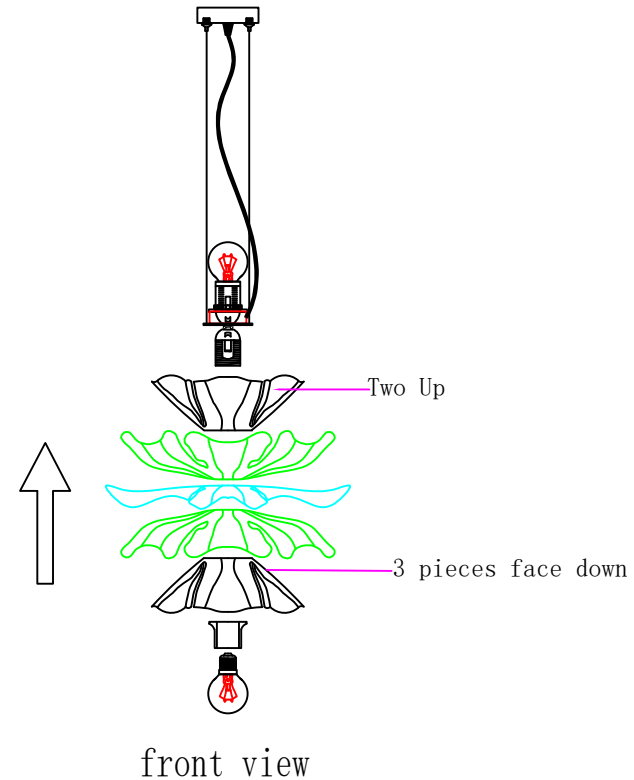
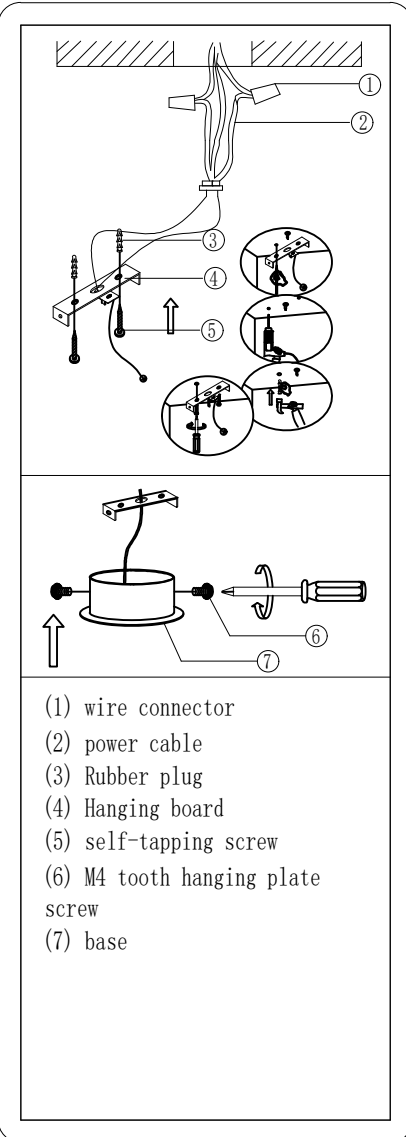
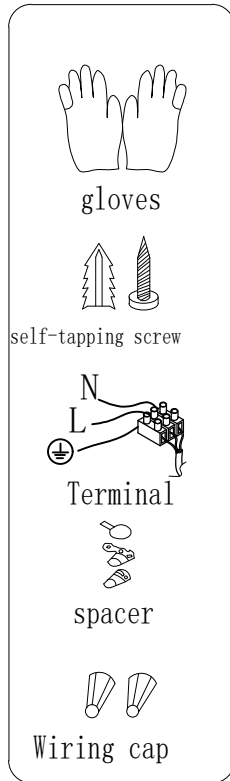

picture 1

1. Fix the bracket(3) on the ceiling with self-drilling screw(4) tightly
2. Pls care the L and N wire during wire connecting, and this connection should be very tightly, without connector dropping when you pull it
3. After Two barcket screws(8) going through base(12) and bracket. Fix the screw with two small deco knob

picture 2

1. Fix the triangle(17) on the ceiling with screw(7), Then fix hanging Ring(18).
2. Connect the hanging ring(16) and the chain(18)
3. The power cable(2) and earth wire(6) will go through the chain, hanging ring(18), canopy(14), thread tube and so on

4. After connecting the power wire, Push the canopy to the ceiling, then fix safety screw tightly

picture 3 assembling way just like Picture 1