

1 Tighten the lamp arm with a nut

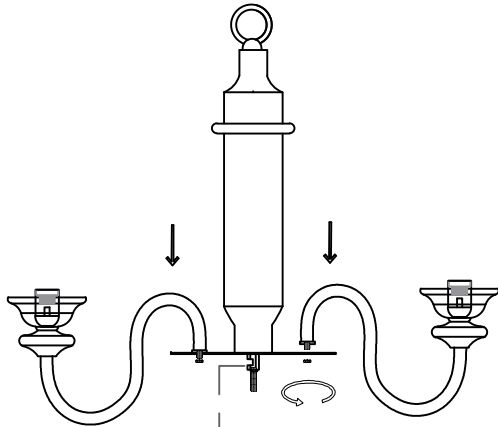

2

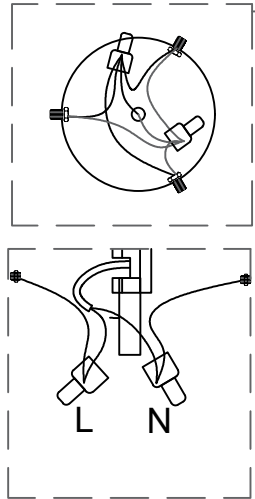

The power cord of the lamp arm is connected to the main line, L/N

3

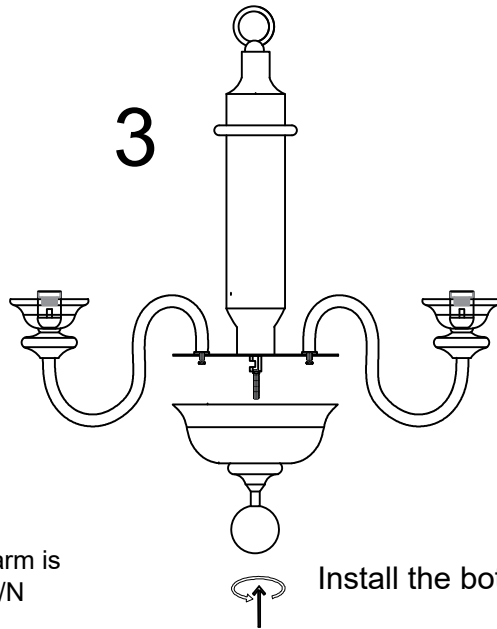

Install the bottom bracket

4

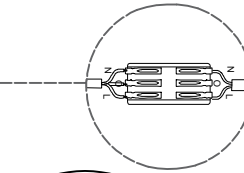
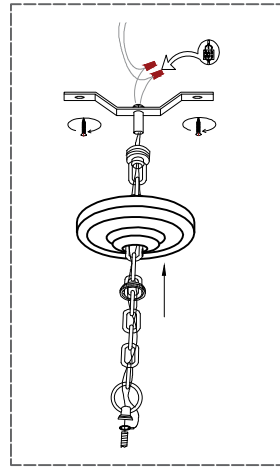

Fix the hanging board to the ceiling

Connect the lamp wires to the reserved wires

Connect the lamp body to the hanging plate

Tighten the suction cup with a ring

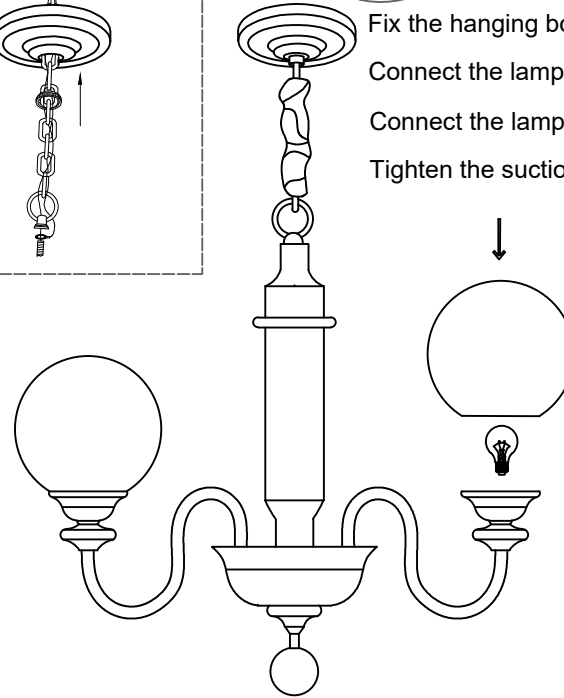

Install bulb and lampshade