

1

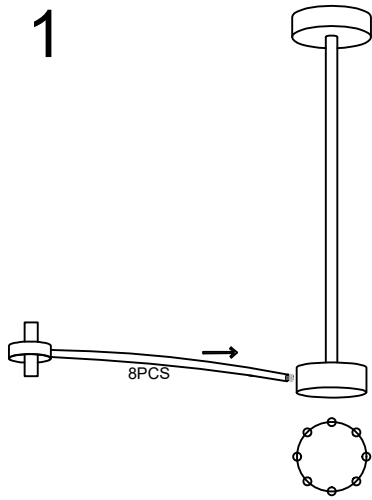

Drill holes in the ceiling and insert expansion screws

2

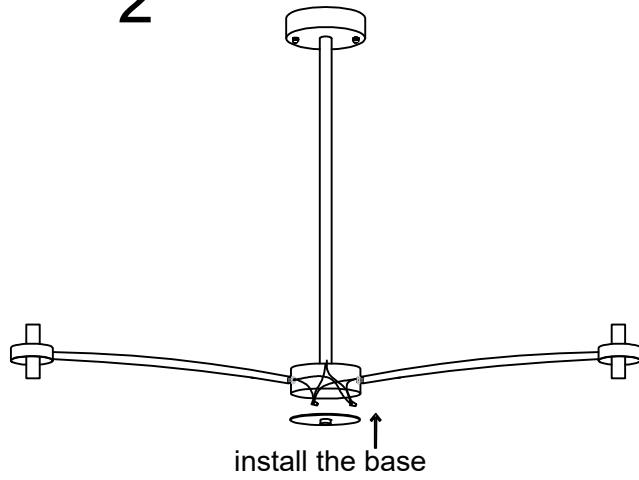

The lamp arm wire is connected to the main line(Lines of the same color are joined together)

3

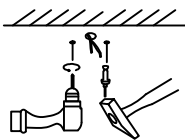

Drill holes in the ceiling and insert expansion screws

5

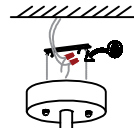

Install the lamp body on the hanging plate

4



Install the hanging plate on the ceiling

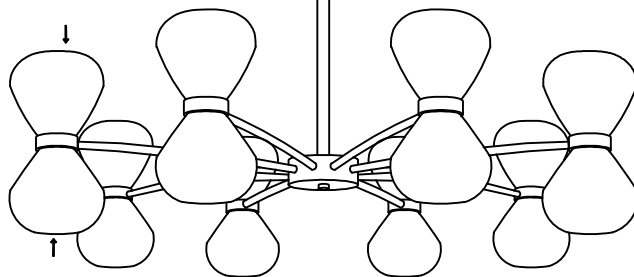

Install lampshade

Note: Please turn off the power before installing the lamp