

1
The lamp arm is connected to the center post by screws

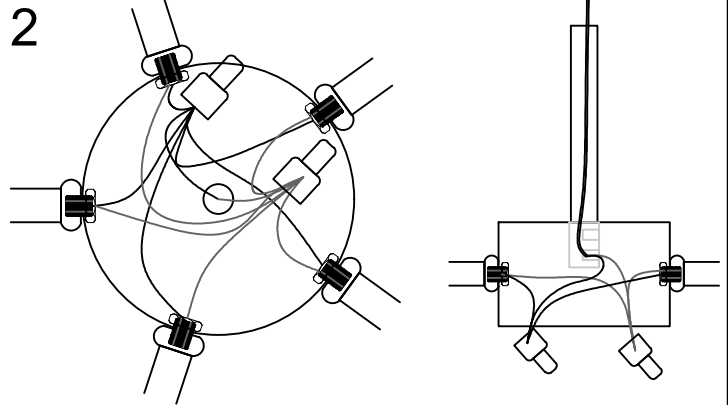

2
The lines of the same color are connected together and then connected with two lines that are respectively connected with the main line

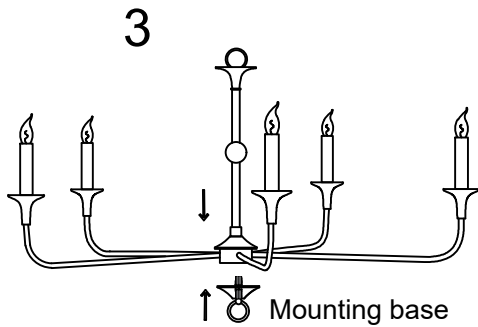

3
Insert into the center tube

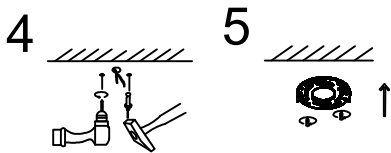

4
Drill holes in the ceiling and insert expansion screws

5
Install the hanging plate on the ceiling

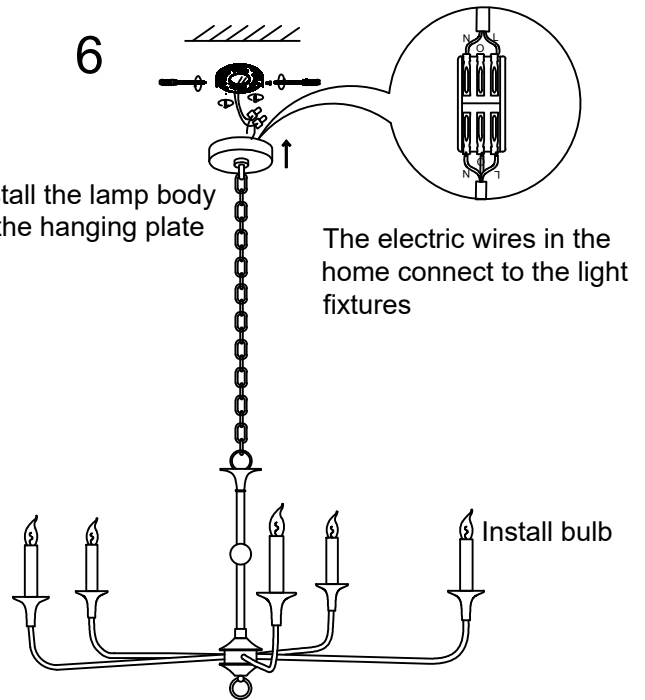

6
Install the lamp body on the hanging plate

The electric wires in the home connect to the light fixtures

Install bulb

Note: Please turn off the power before installing the lamp