

1

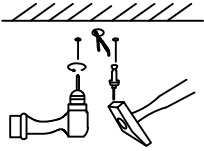

Drill holes in the ceiling and insert expansion screws

2

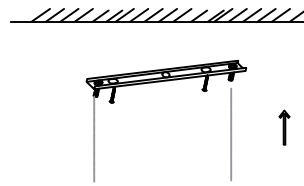

Install the hanging plate on the ceiling

3

The electric wires in the home connect to the light fixtures

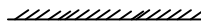

Install the lamp body on the hanging plate

Wire adjustable

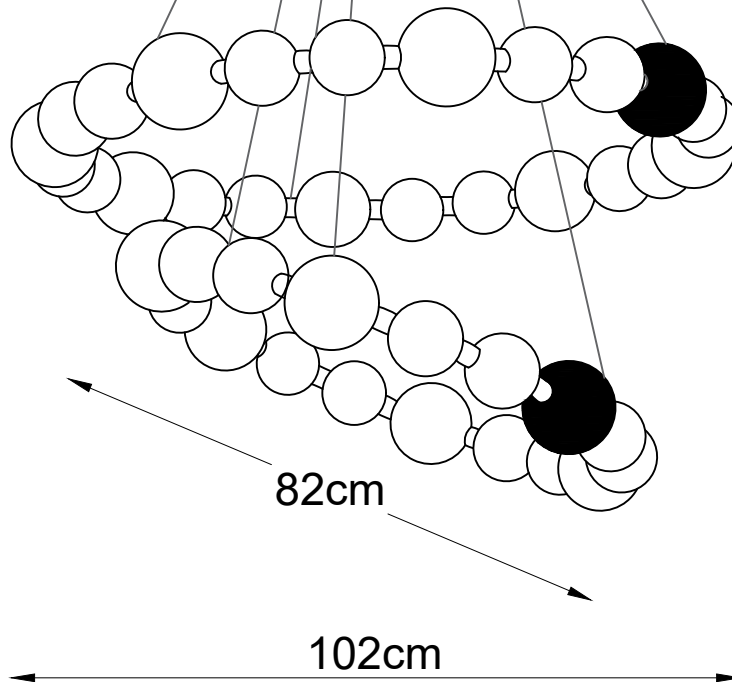

Note: Please turn off the power before installing the lamp

1

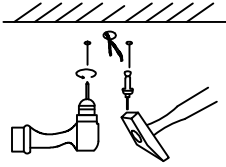

Drill holes in the ceiling and insert expansion screws

2

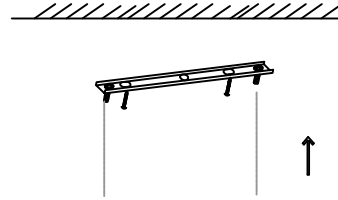

Install the hanging plate on the ceiling

3

The electric wires in the home connect to the light fixtures

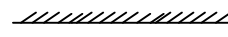

Install the lamp body on the hanging plate

Wire adjustable

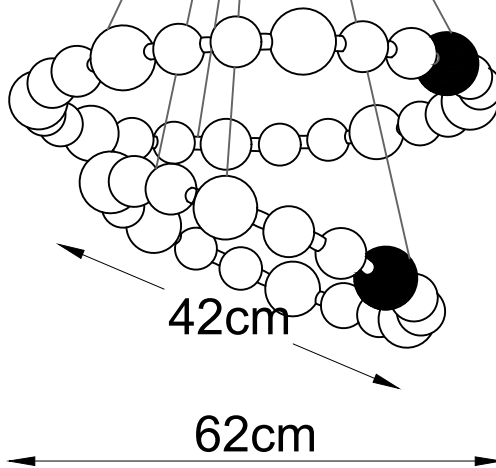

Note: Please turn off the power before installing the lamp

1

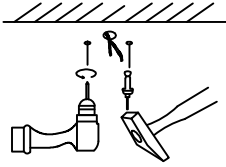

Drill holes in the ceiling and insert expansion screws

2

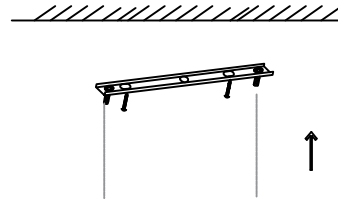

Install the hanging plate on the ceiling

3

The electric wires in the home connect to the light fixtures

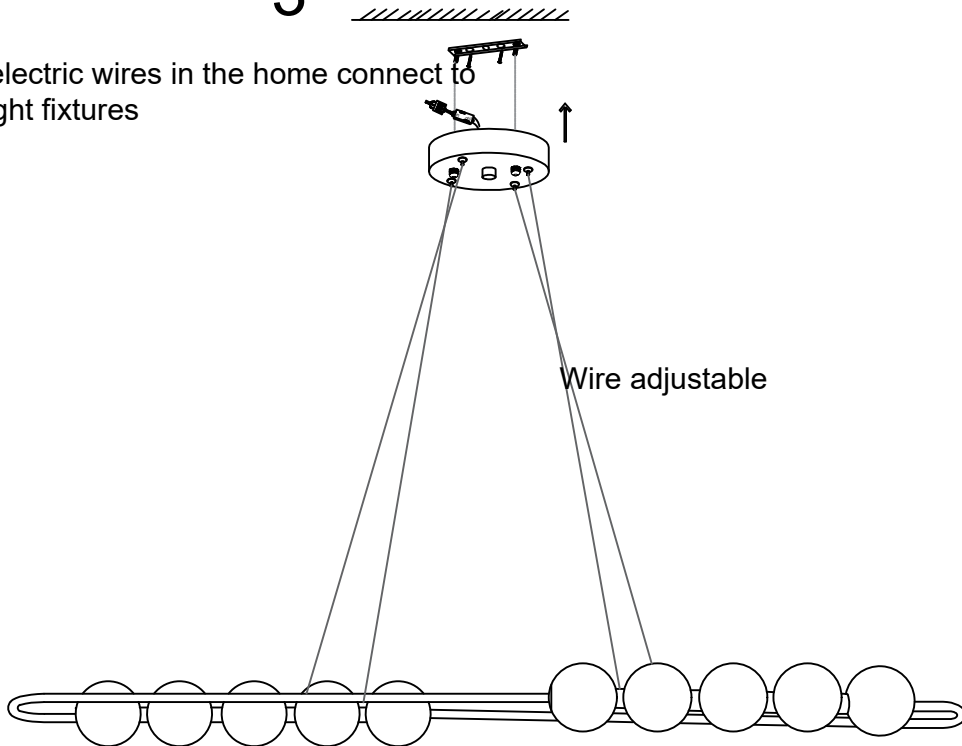

Install the lamp body on the hanging plate

Note: Please turn off the power before installing the lamp

1

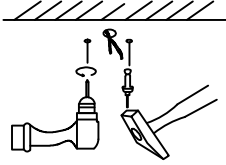

Drill holes in the ceiling and insert expansion screws

2

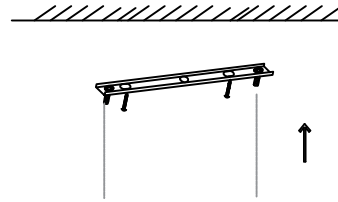

Install the hanging plate on the ceiling

3

The electric wires in the home connect to the light fixtures

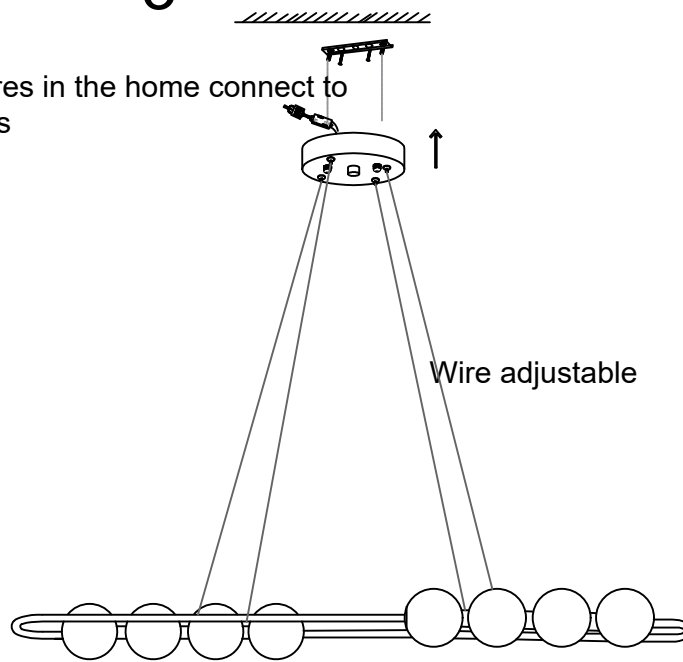

Install the lamp body on the hanging plate

Note: Please turn off the power before installing the lamp

1

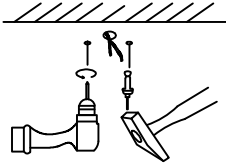

Drill holes in the ceiling and insert expansion screws

2

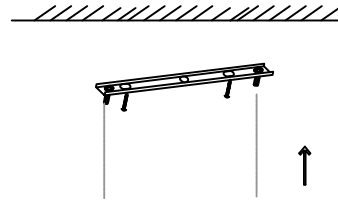

Install the hanging plate on the ceiling

3

The electric wires in the home connect to the light fixtures

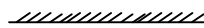

Install the lamp body on the hanging plate

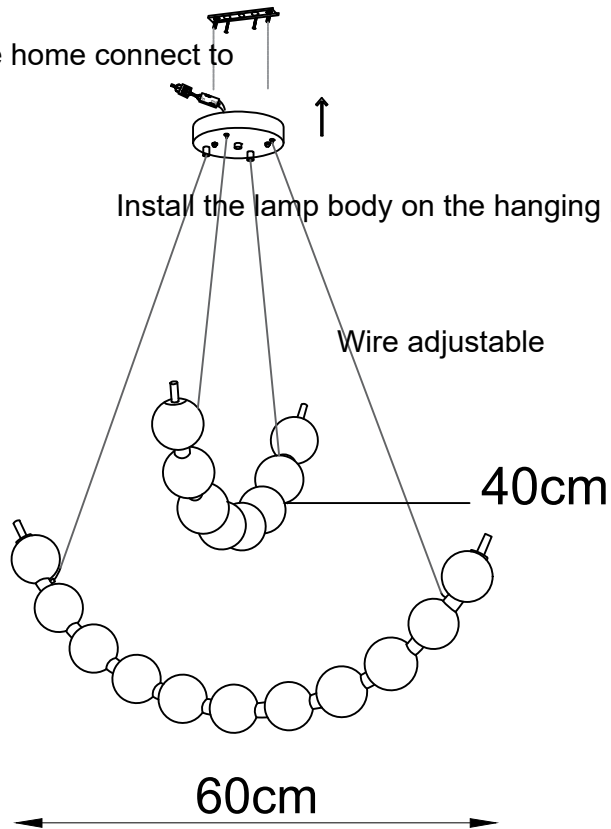

Note: Please turn off the power before installing the lamp

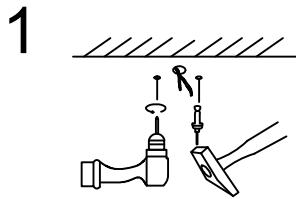

Drill holes in the ceiling and insert expansion screws

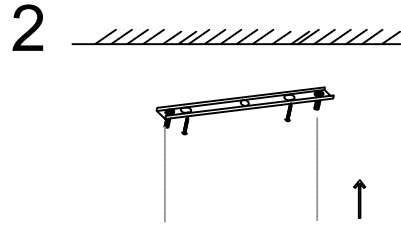

Install the hanging plate on the ceiling

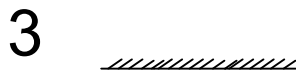

The electric wires in the home connect to the light fixtures

Install the lamp body on the hanging plate

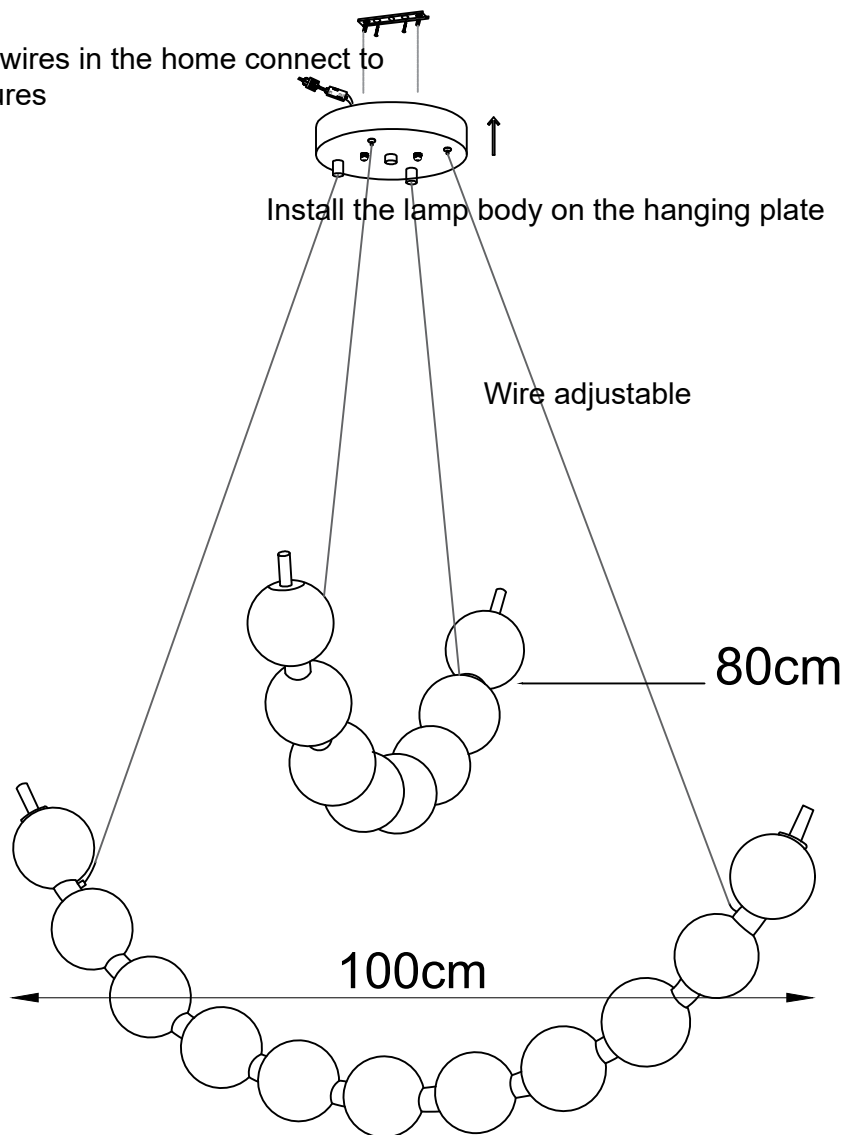

Note: Please turn off the power before installing the lamp

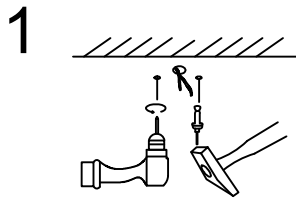

Drill holes in the ceiling and insert expansion screws

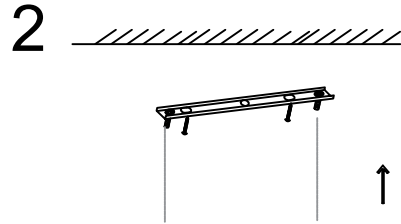

Install the hanging plate on the ceiling

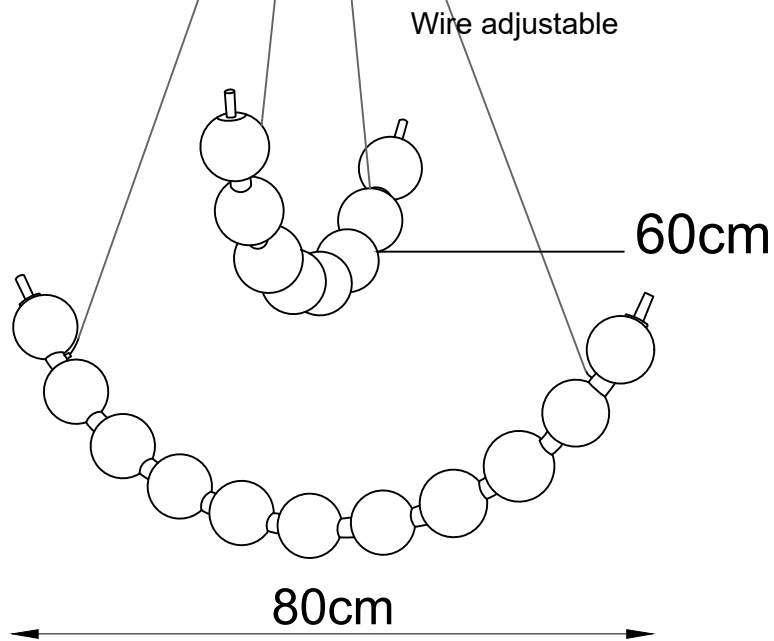
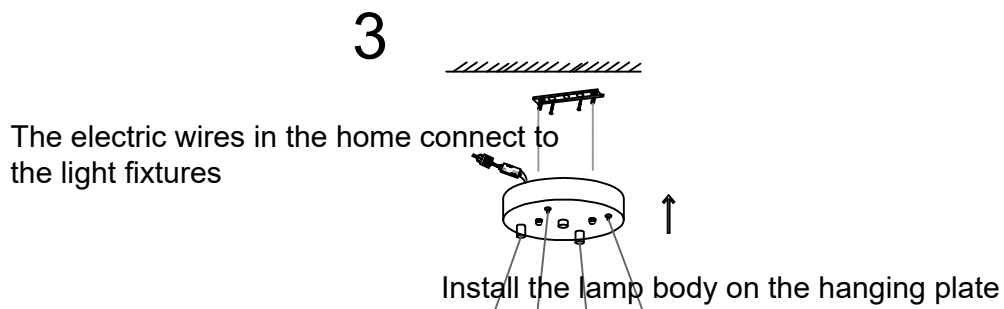

Note: Please turn off the power before installing the lamp

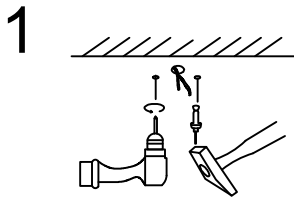

Drill holes in the ceiling and insert expansion screws

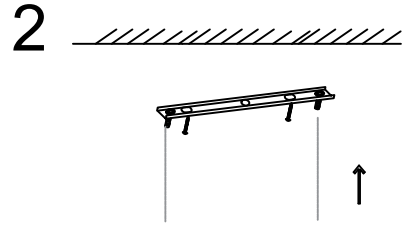

Install the hanging plate on the ceiling

3

The electric wires in the home connect to the light fixtures



Install the lamp body on the hanging plate

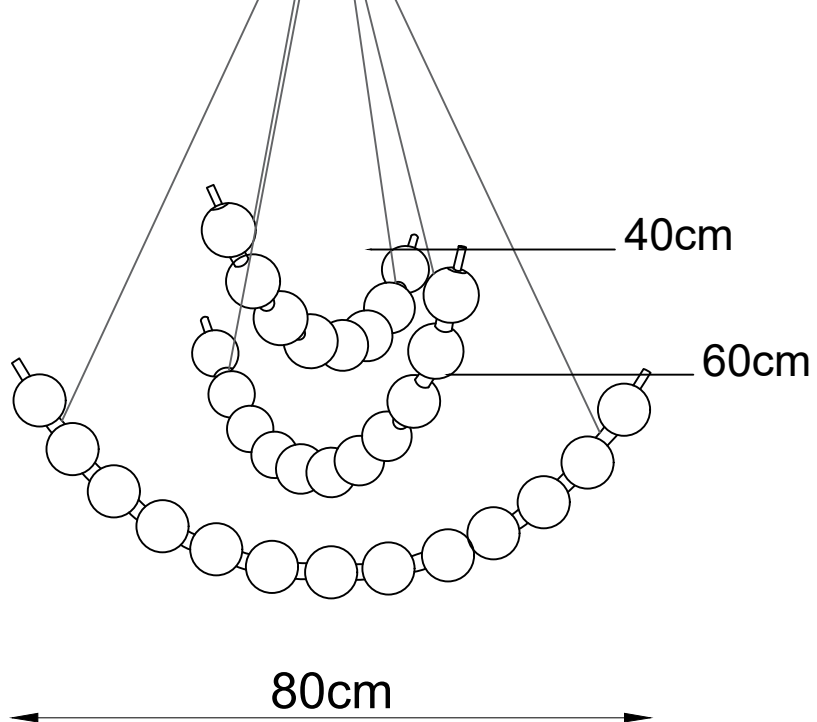

Note: Please turn off the power before installing the lamp

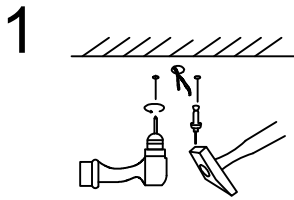

Drill holes in the ceiling and insert expansion screws

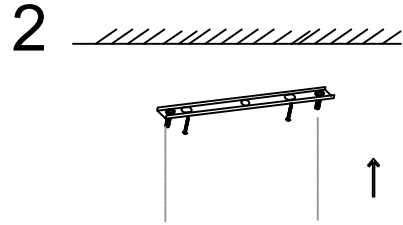

Install the hanging plate on the ceiling

3

The electric wires in the home connect to the light fixtures

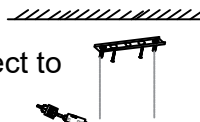

Install the lamp body on the hanging plate

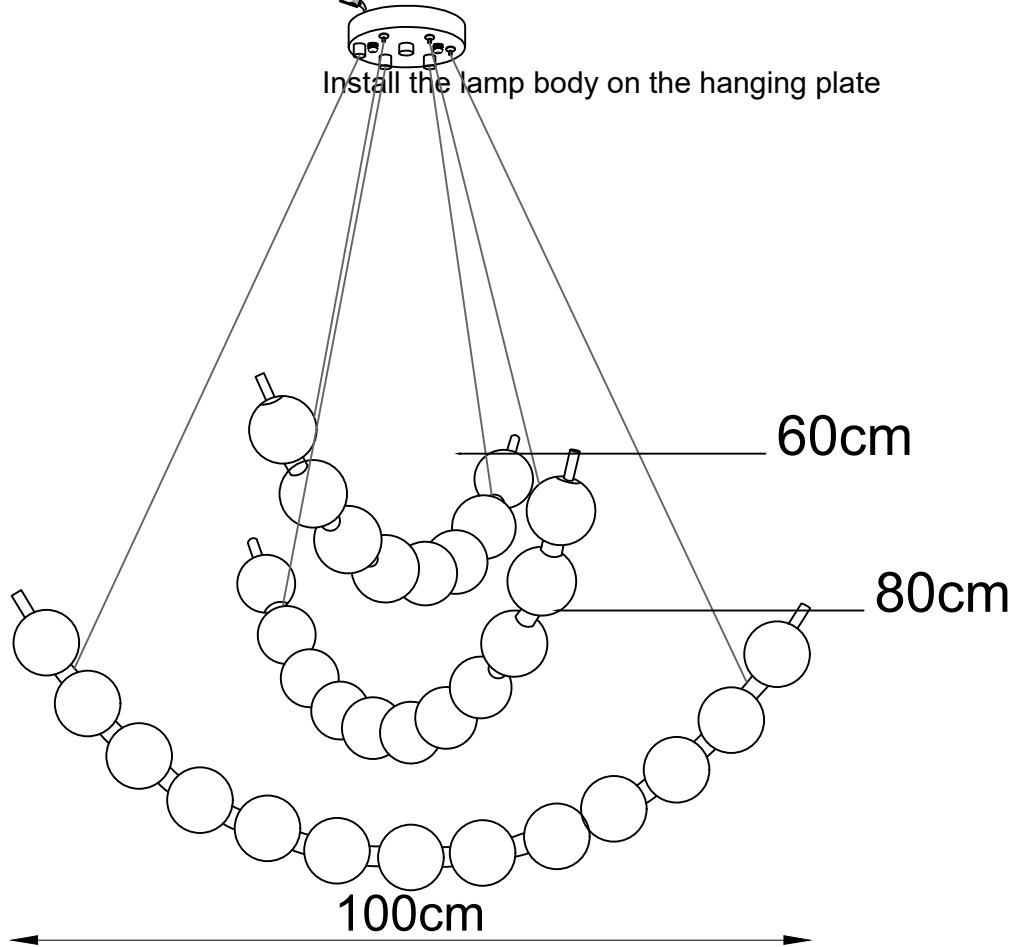

Note: Please turn off the power before installing the lamp

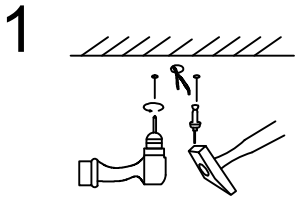

Drill holes in the ceiling and insert expansion screws

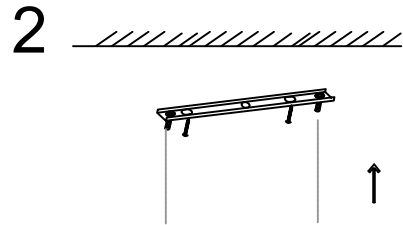

Install the hanging plate on the ceiling

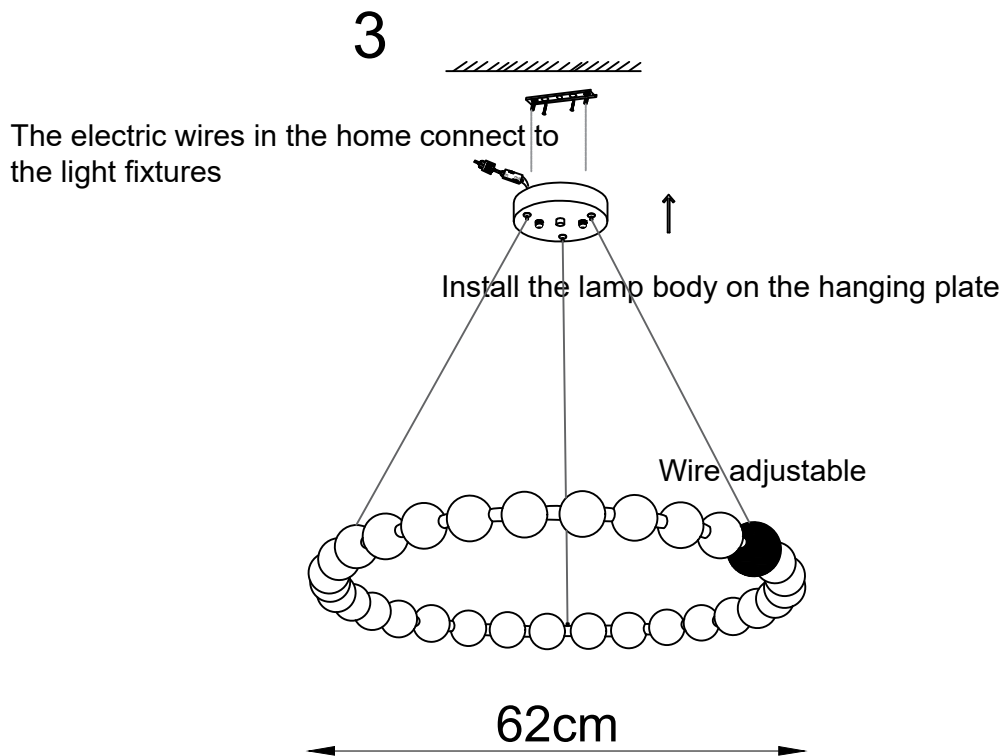

Note: Please turn off the power before installing the lamp

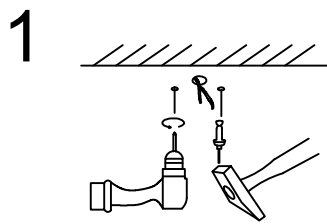

Drill holes in the ceiling and insert expansion screws

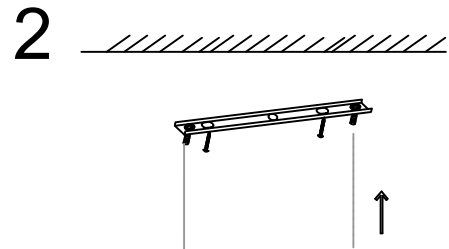

Install the hanging plate on the ceiling

3

The electric wires in the home connect to the light fixtures

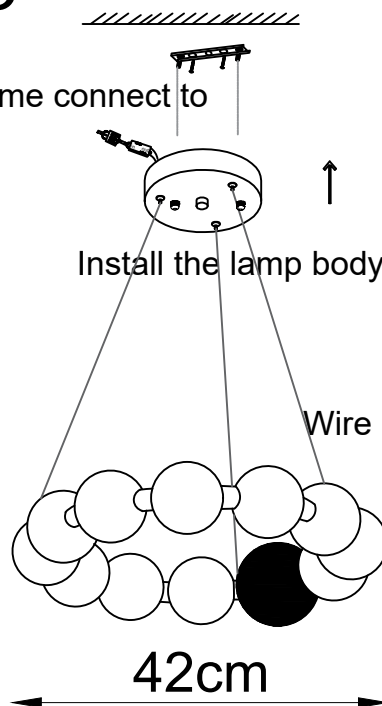

Install the lamp body on the hanging plate

Wire adjustable

42cm

Note: Please turn off the power before installing the lamp

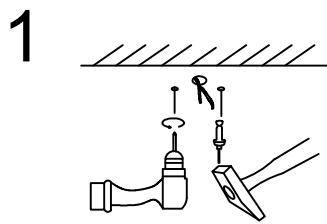

Drill holes in the ceiling and insert expansion screws

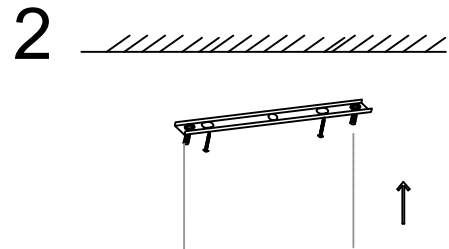

Install the hanging plate on the ceiling

3

The electric wires in the home connect to the light fixtures



Install the lamp body on the hanging plate

Wire adjustable

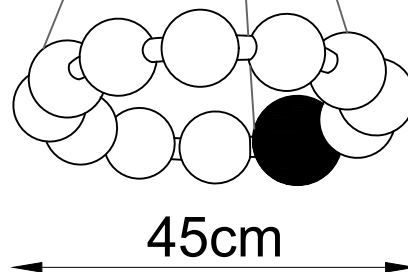

Note: Please turn off the power before installing the lamp

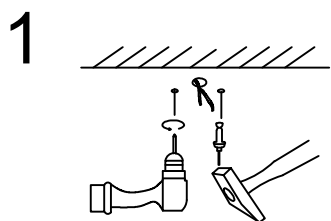

Drill holes in the ceiling and insert expansion screws

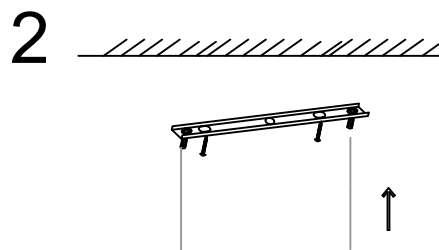

Install the hanging plate on the ceiling

3

The electric wires in the home connect to the light fixtures



Install the lamp body on the hanging plate

Wire adjustable

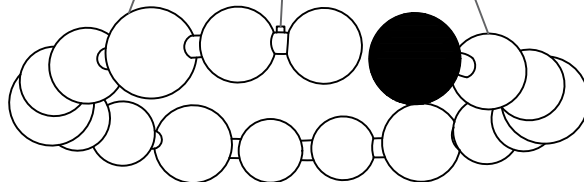

65cm

Note: Please turn off the power before installing the lamp

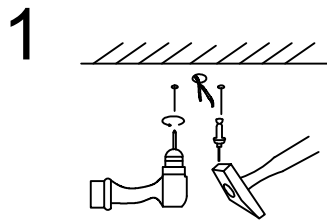

Drill holes in the ceiling and insert expansion screws

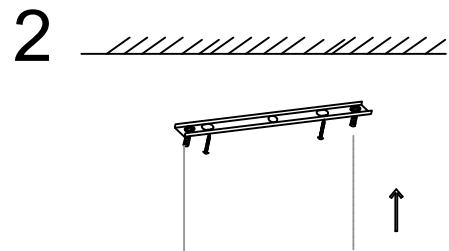

Install the hanging plate on the ceiling

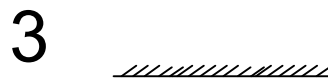

The electric wires in the home connect to the light fixtures

Install the lamp body on the hanging plate

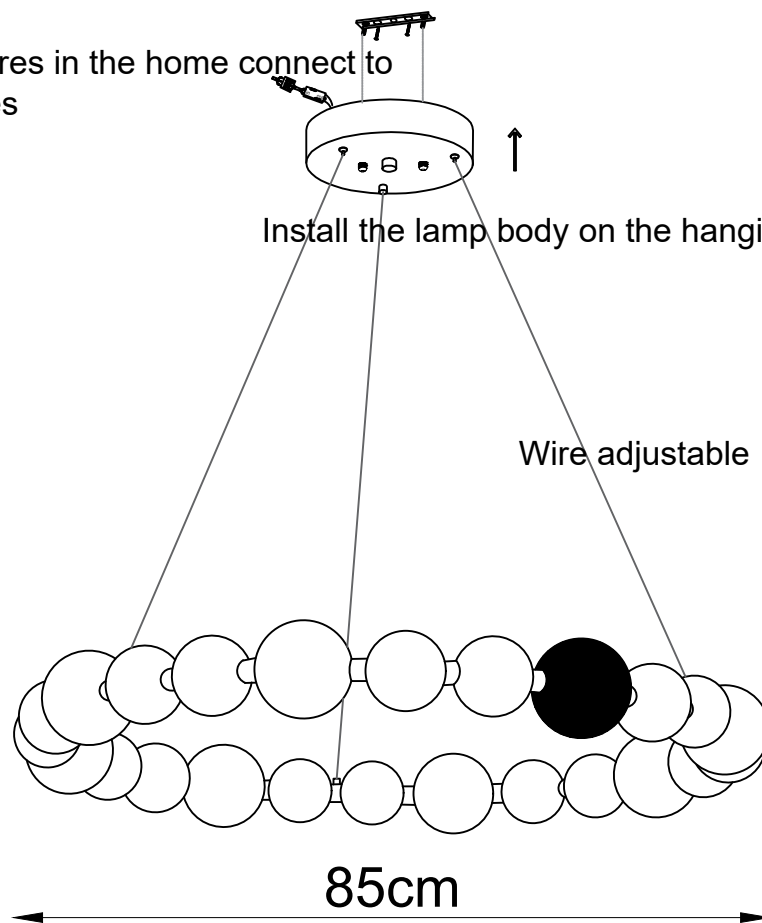

85cm

Note: Please turn off the power before installing the lamp

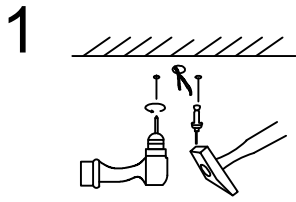

Drill holes in the ceiling and insert expansion screws

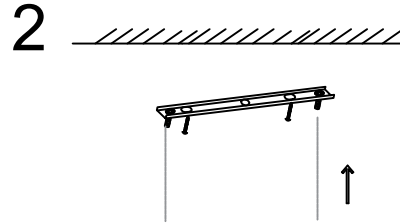

Install the hanging plate on the ceiling

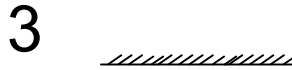

The electric wires in the home connect to the light fixtures

Install the lamp body on the hanging plate

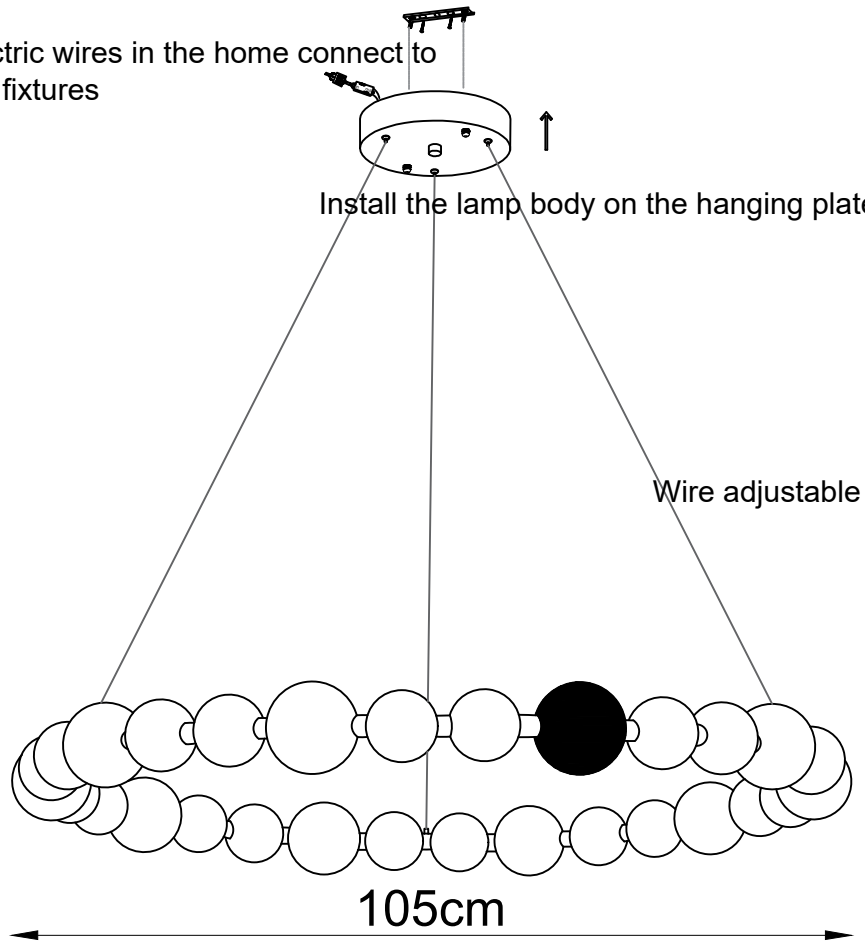

Note: Please turn off the power before installing the lamp

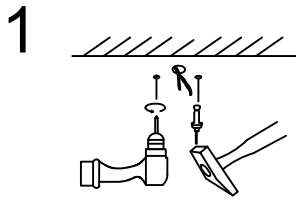

Drill holes in the ceiling and insert expansion screws

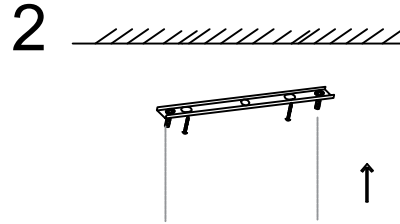

Install the hanging plate on the ceiling

3

The electric wires in the home connect to the light fixtures

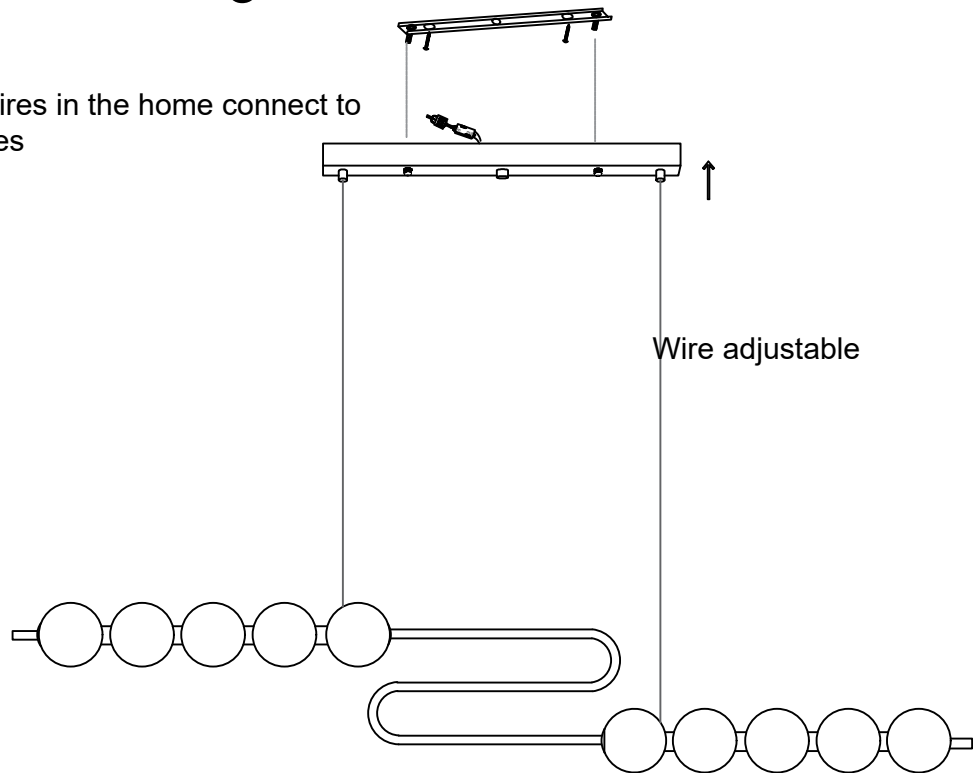

Install the lamp body on the hanging plate

Note: Please turn off the power before installing the lamp

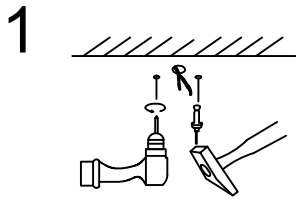

Drill holes in the ceiling and insert expansion screws

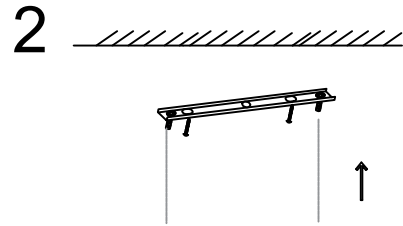

Install the hanging plate on the ceiling

3

The electric wires in the home connect to the light fixtures

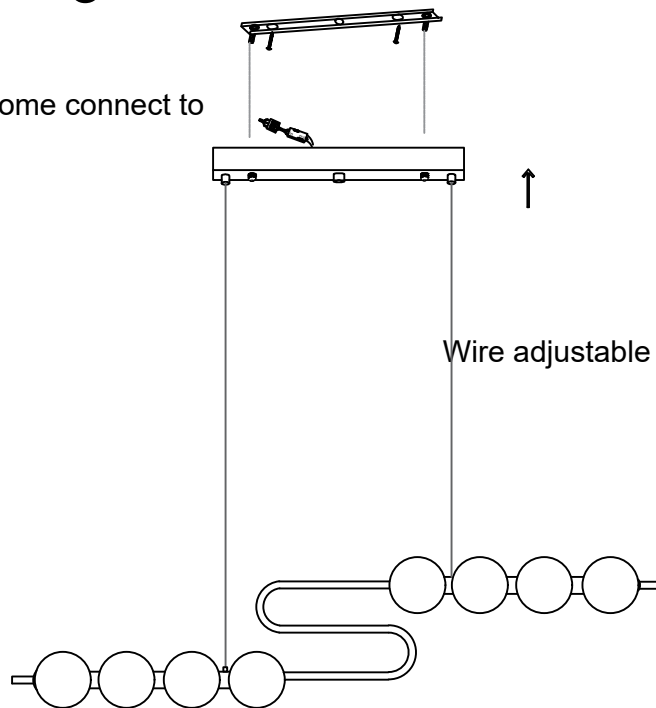

Install the lamp body on the hanging plate

Note: Please turn off the power before installing the lamp

1

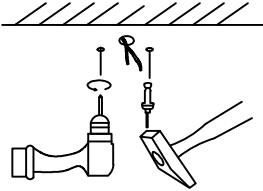

Drill holes in the ceiling and insert expansion screws

2

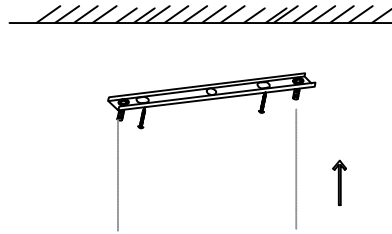

Install the hanging plate on the ceiling

3

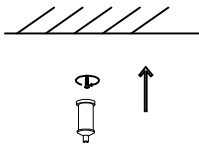

After confirming the distance, install a small ceiling on the other side of the ceiling

4

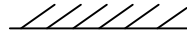

Wire adjustable

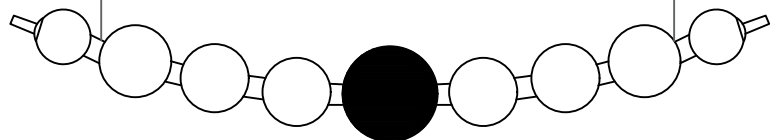

Install the lamp body on the hanging plate

Note: Please turn off the power before installing the lamp

1

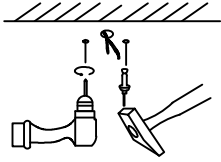

Drill holes in the ceiling and insert expansion screws

2

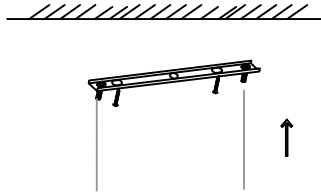

Install the hanging plate on the ceiling

3

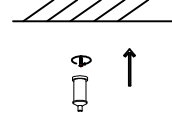

After confirming the distance, install a small ceiling on the other side of the ceiling

4

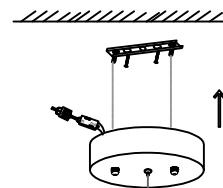
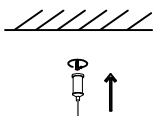

Install the lamp body on the hanging plate

Wire adjustable

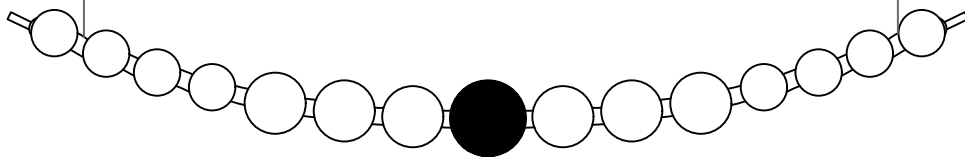

Note: Please turn off the power before installing the lamp

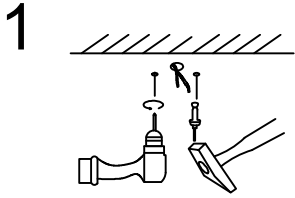

Drill holes in the ceiling and insert expansion screws

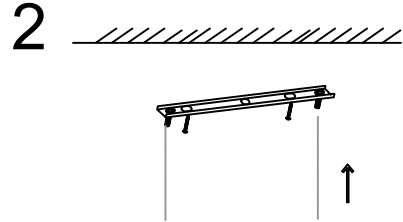

Install the hanging plate on the ceiling

3

The electric wires in the home connect to the light fixtures

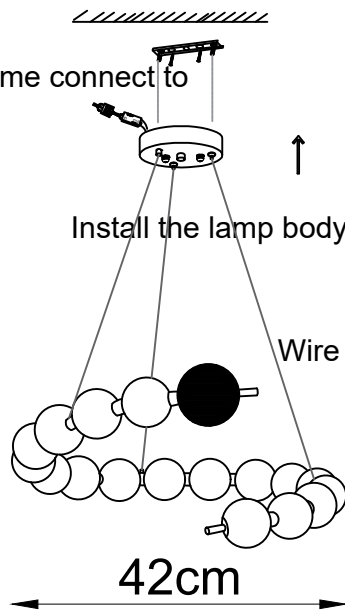

Install the lamp body on the hanging plate

Wire adjustable

42cm

Note: Please turn off the power before installing the lamp

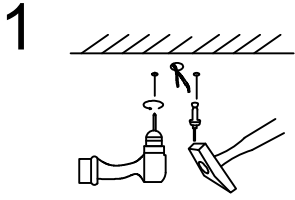

Drill holes in the ceiling and insert expansion screws

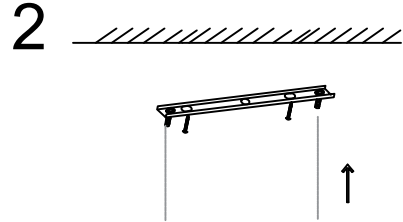

Install the hanging plate on the ceiling

3

The electric wires in the home connect to the light fixtures

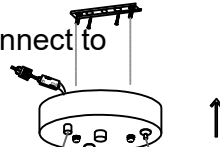
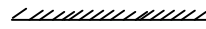

Install the lamp body on the hanging plate

Wire adjustable

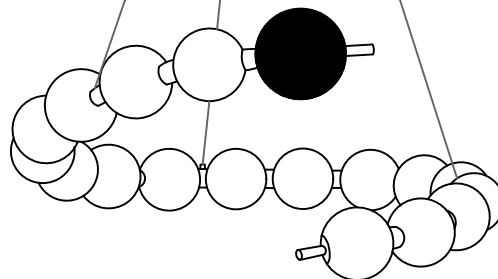

62cm



Note: Please turn off the power before installing the lamp

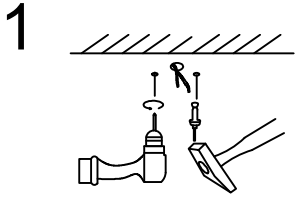

Drill holes in the ceiling and insert expansion screws

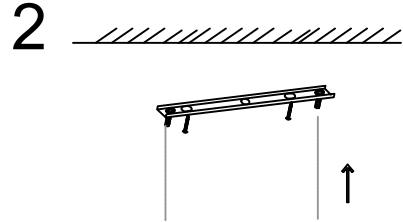

Install the hanging plate on the ceiling

3

The electric wires in the home connect to the light fixtures

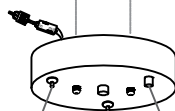
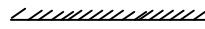

Install the lamp body on the hanging plate



Wire adjustable

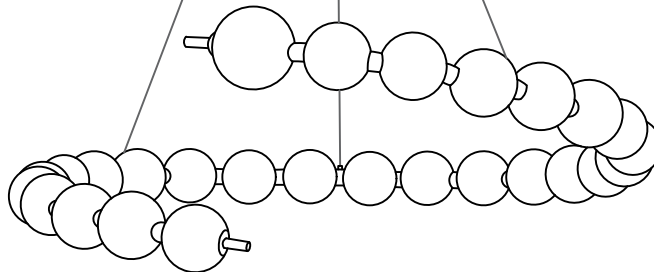

82cm



Note: Please turn off the power before installing the lamp

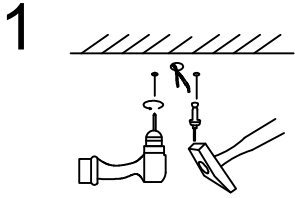

Drill holes in the ceiling and insert expansion screws

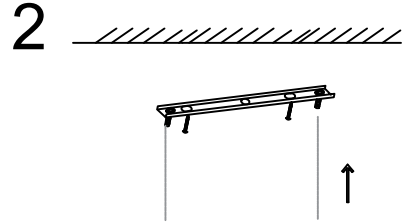

Install the hanging plate on the ceiling

3

The electric wires in the home connect to the light fixtures

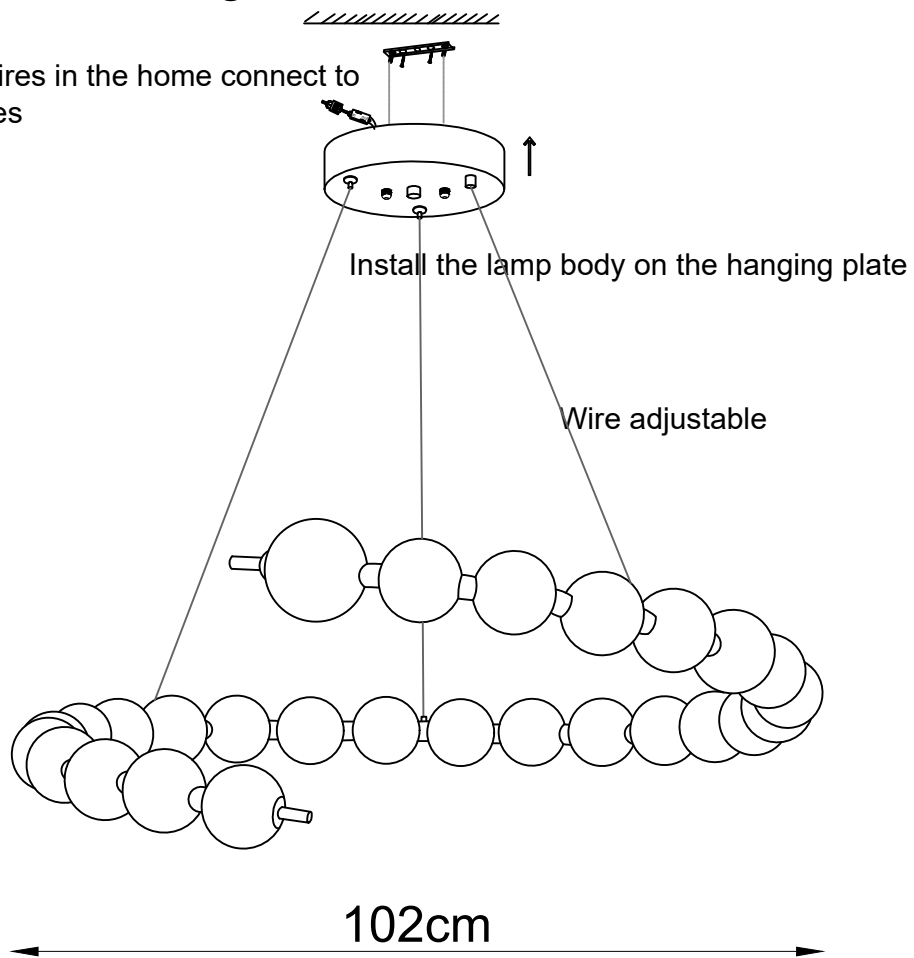

Install the lamp body on the hanging plate

Wire adjustable

102cm

Note: Please turn off the power before installing the lamp