

1

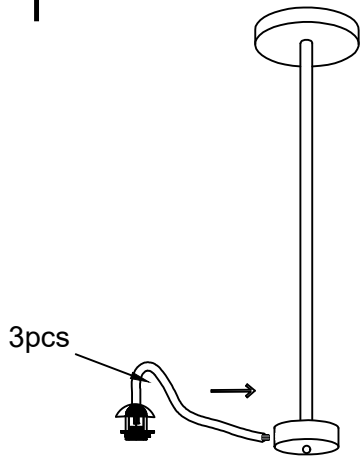

Mounting lamp body: the lamp arm is connected to the center post by screws

2

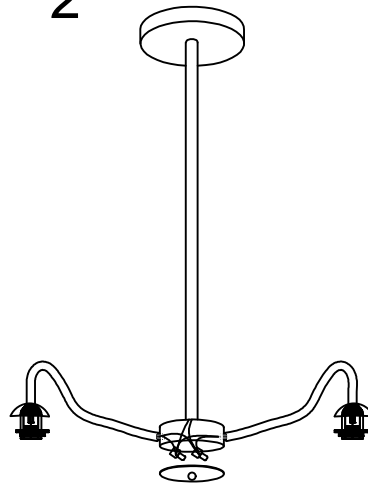

The lamp arm wire is connected to the main line

3

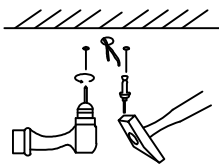

Drill holes in the ceiling and insert expansion screws

4

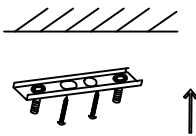

Install the hanging plate on the ceiling

5

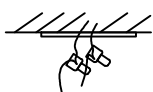

The electric wires in the home connect to the light fixtures

6

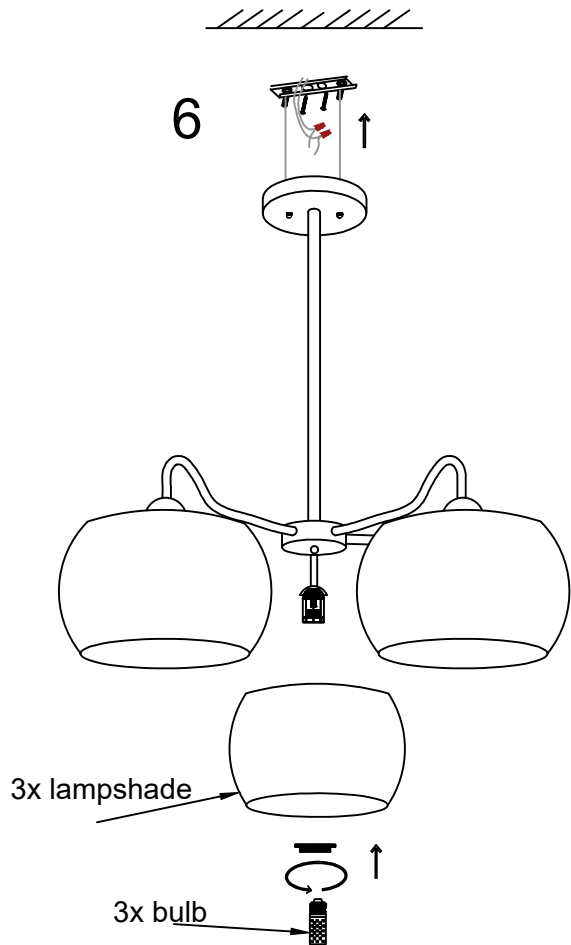

3x lampshade

3x bulb

Install bulbs and lampshades