

# Tulip Matcha Chandelier-8

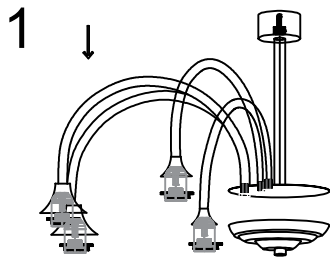

1  
Mounting lamp body: the lamp arm is connected to the center post by screws

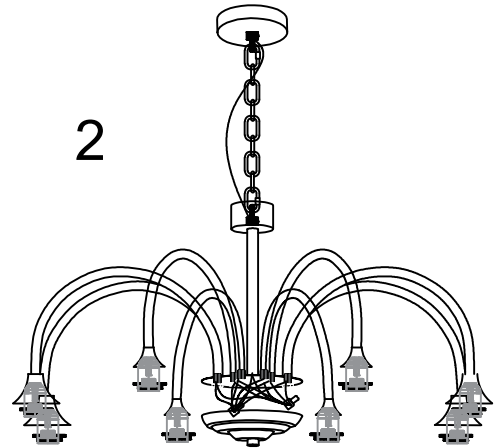

2  
The lamp arm wire is connected to the main line

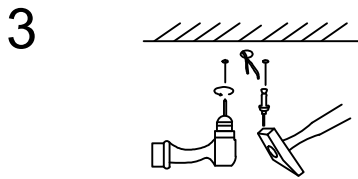

3  
Drill holes in the ceiling and insert expansion screws



4  
Install the hanging plate on the ceiling

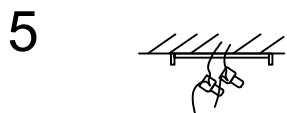

5  
The electric wires in the home connect to the light fixtures

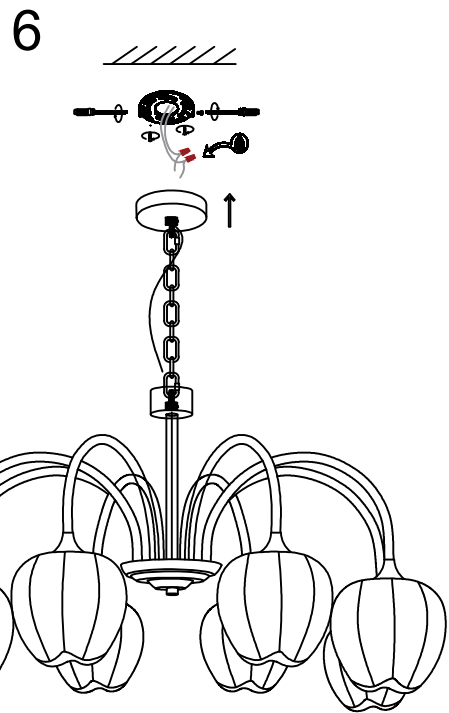

6  
8x lampshade

8x bulb

Install bulbs and lampshades