

Tulip Matcha Chandelier-6

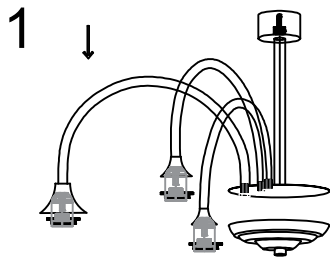

Mounting lamp body: the lamp arm is connected to the center post by screws

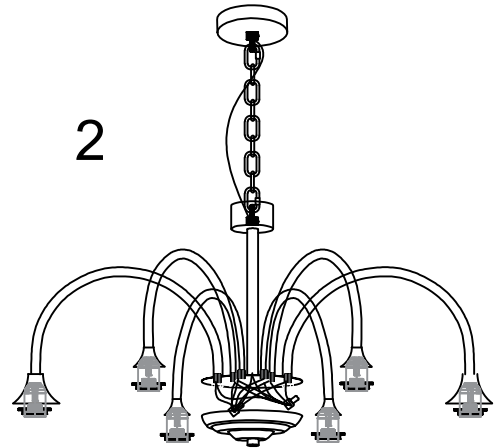

The lamp arm wire is connected to the main line

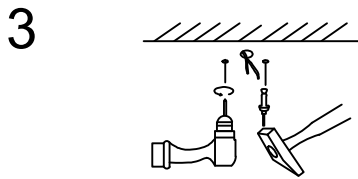

Drill holes in the ceiling and insert expansion screws



Install the hanging plate on the ceiling



The electric wires in the home connect to the light fixtures

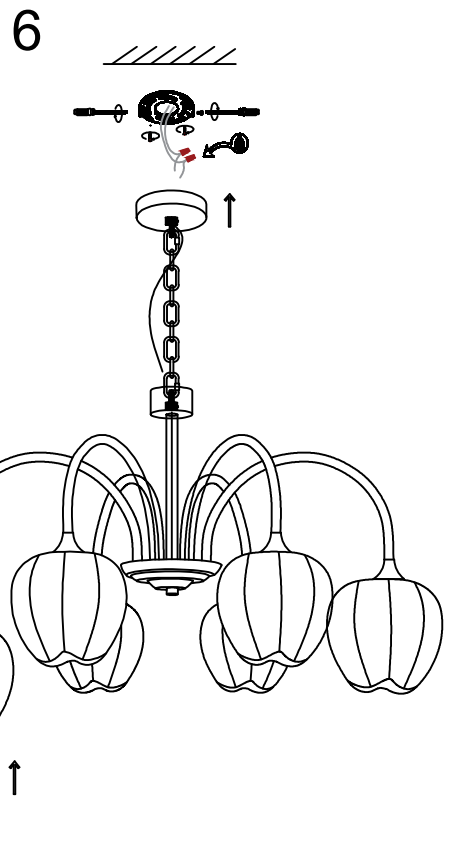

6x lampshade

6x bulb

Install bulbs and lampshades