

1

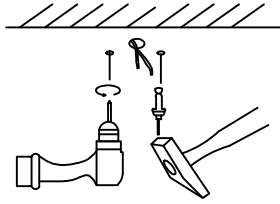

Drill holes in the cell and
insert expansion screws

2

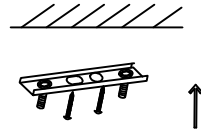

Install the hanging plate on
the ceiling

3

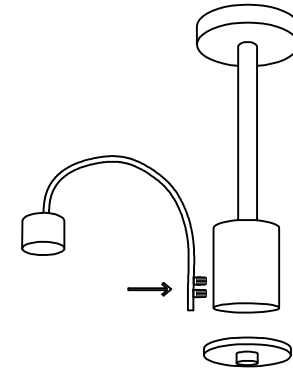

Mounting lamp body: the lamp arm
is connected to the center post by
screws

4

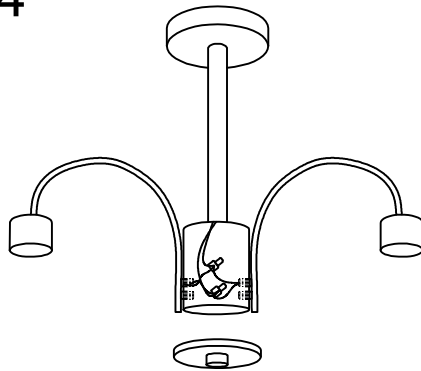

The lamp arm wire is connected to
the main line

5

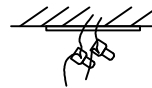

The electric wires in the home
connect to the light fixtures

6

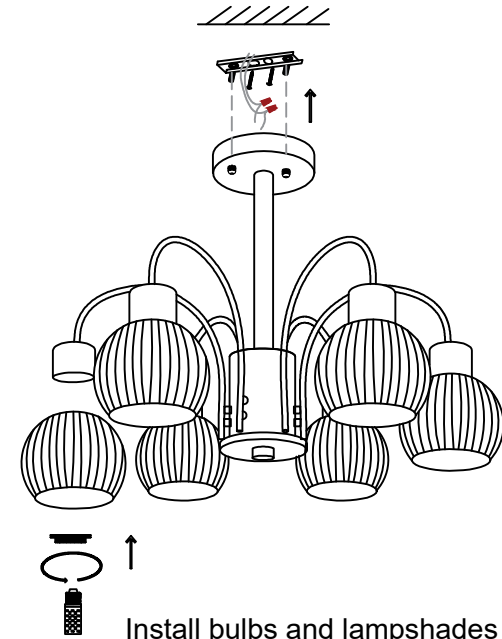

Install bulbs and lampshades

notice:

When maintaining the lamp, be sure to cut off
the power supply to prevent leakage
Please wear gloves when installing