

Use pliers to pull on the steel wire  
Hang into the hole from the gap

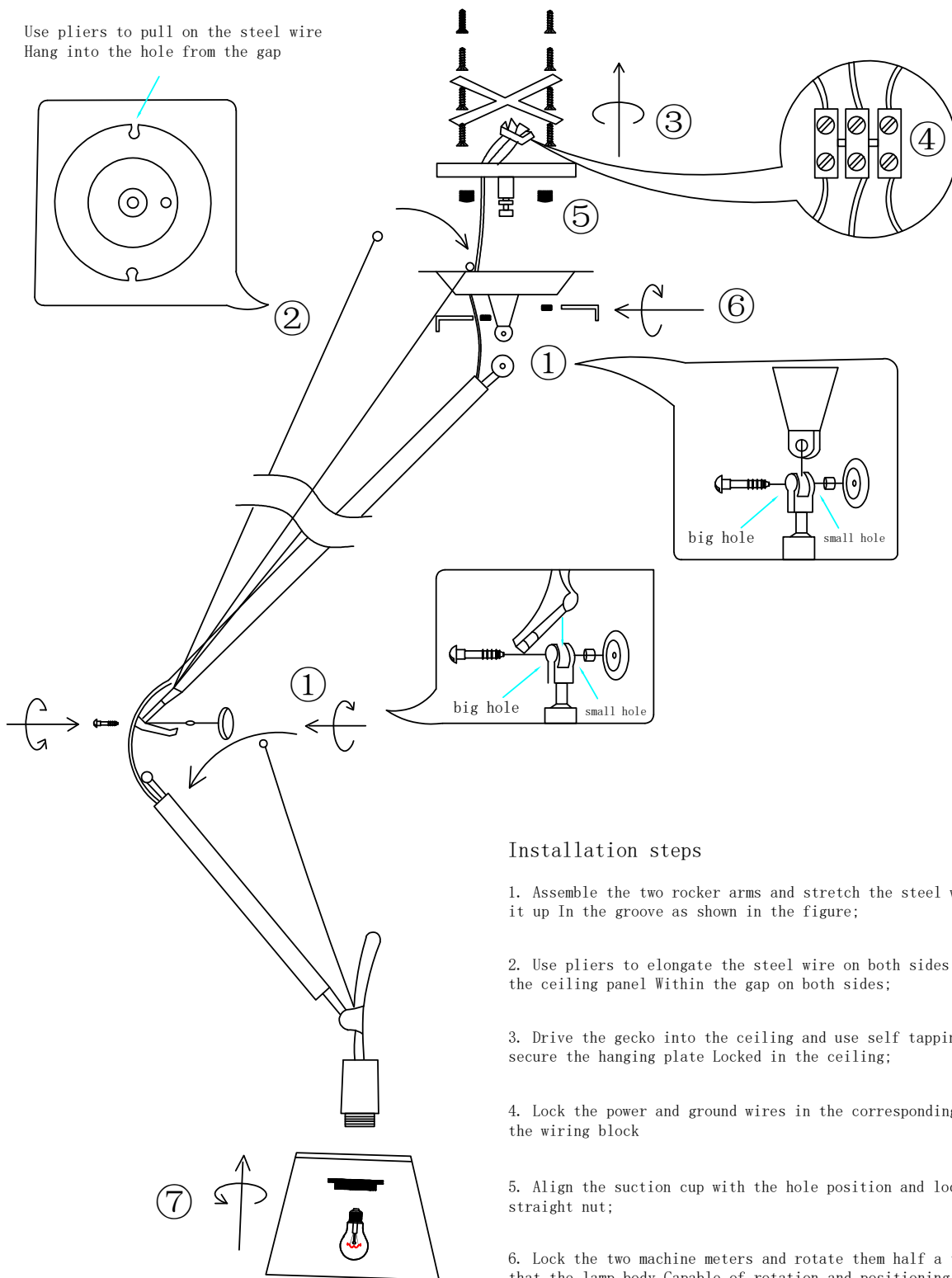

### Installation steps

1. Assemble the two rocker arms and stretch the steel wire to buckle it up In the groove as shown in the figure;
2. Use pliers to elongate the steel wire on both sides and hang it on the ceiling panel Within the gap on both sides;
3. Drive the gecko into the ceiling and use self tapping screws to secure the hanging plate Locked in the ceiling;
4. Lock the power and ground wires in the corresponding positions on the wiring block
5. Align the suction cup with the hole position and lock it with a straight nut;
6. Lock the two machine meters and rotate them half a turn to ensure that the lamp body Capable of rotation and positioning
7. Place the lampshade on the lamp holder, and the lamp holder ring can lock the lampshade