

1: Fix the hanging board to the ceiling

2: Connect the lamp wires to the reserved wires

3: Fix the ceiling tray and hanging board from the side

4: Installing bulb

5: Install the lampshade

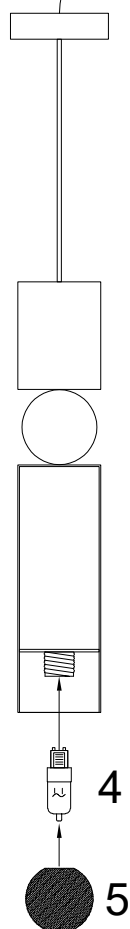
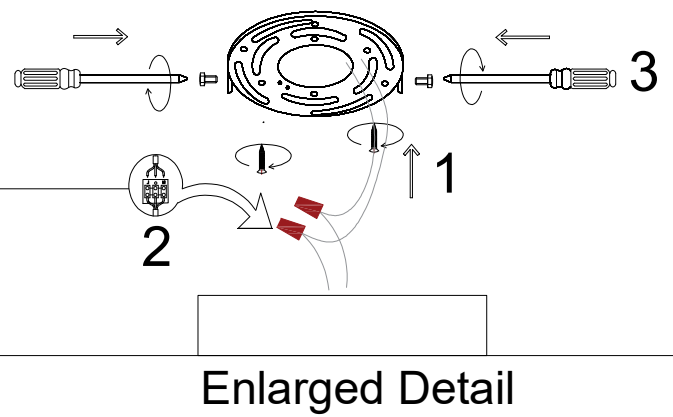
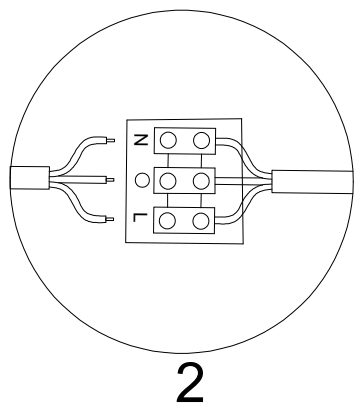

- 1: Fix the hanging board to the ceiling
- 2: Connect the lamp wires to the reserved wires
- 3: Tighten the nut to secure the lamp body
- 4: Installing bulb
- 5: Install the lampshade

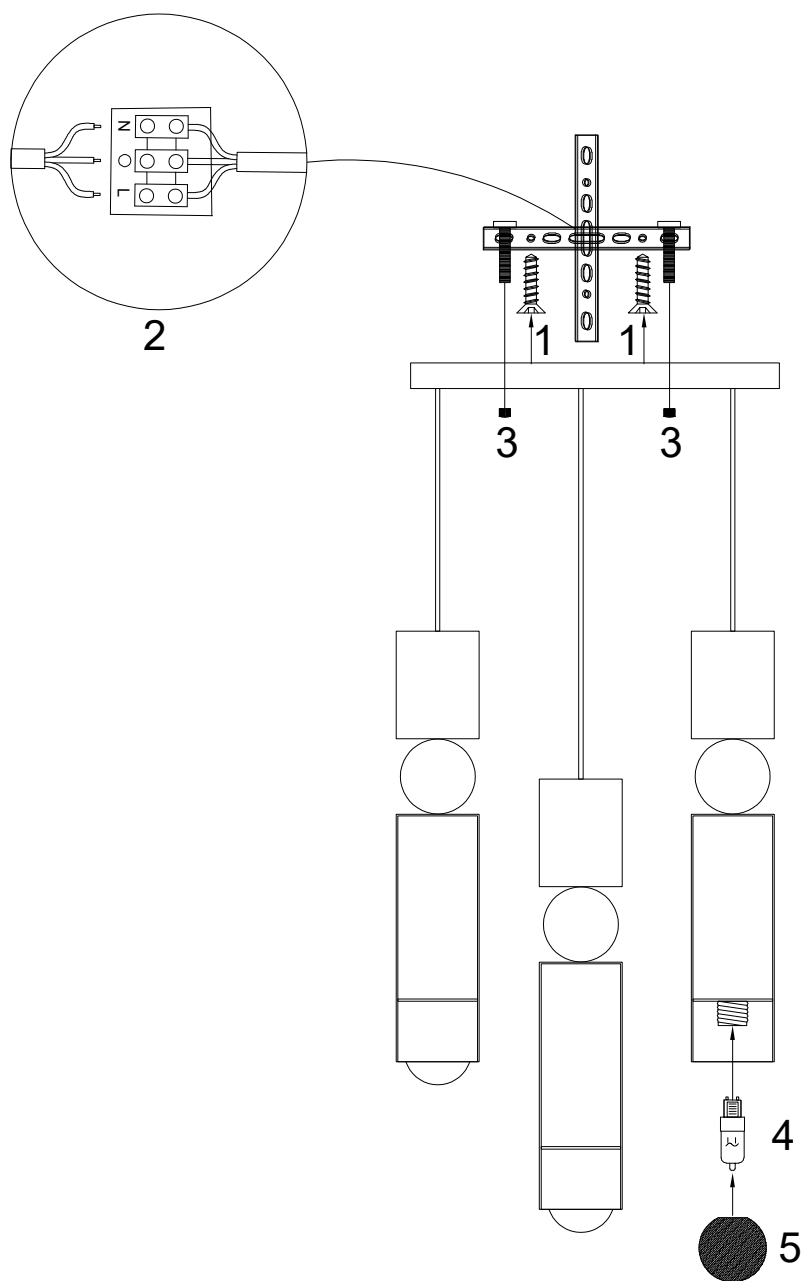

- 1: Fix the hanging board to the ceiling
- 2: Connect the lamp wires to the reserved wires
- 3: Tighten the nut to secure the lamp body
- 4: Installing bulb
- 5: Install the lampshade

